

The Good Life

£159,000

65ft widebeam



Lying at Bradford on Avon

Contact via Hilperton Marina on 01225 76543

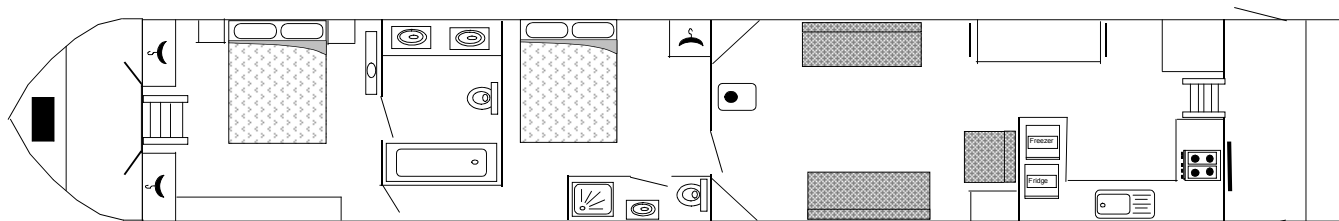

Overall length	65ft	Beam	12ft
Draught	2ft	No. of Berths	4
Stern	n/a	Licensed	10/10
Boat Safety Cert.	Yes	Valid to	03/13
Shell Manufacturer	RLL Boats, Bristol	Date	2004
Fitout	RLL Boats, Bristol	Date	2004
Hull Material	Steel	Thickness	10/6mm
Cabin Material	Steel	Thickness	4/4mm
Engine	John Deere	Model	3 cyl 65HP
Fuel	Diesel	Cooling	Water
Gearbox	PRM	Model	Not known

Whilst every care has been taken in their preparation, the correctness of these details is not guaranteed. They are intended as a guide only and do not constitute a term of any contract. A prospective buyer is strongly advised to check the particulars and where appropriate to employ a qualified marine surveyor to inspect the vessel.

www.boatsales-uk.com

ABC Leisure Group Ltd Reg. Office: Scarfield Wharf, Alvechurch, Worcestershire B48 7SQ Reg. No. 2860394

The Good Life

£159,000

65ft widebeam



A 2004 65ft 4 berth RLL Boats widebeam narrowboat

Interior: Master bedroom with wardrobes, storage & en suite bathroom – bath with shower over, 2 glass basins, macerator toilet and fitted units. Second bedroom with fixed double berth, fitted wardrobe & storage, with adjacent shower room. Large saloon with Belton Bunny solid fuel stove & fireplace surround, TV & storage units, 2 black leather sofas and black leather chair, flat screen TV, Sky Box & DVD. Galley with Neff hob & New World oven, Philips Whirlpool fridge & separate freezer, Zanussi washing machine and tumble dryer. Dining area with table & 4 black leather chairs. Rear wheel house & engine room. Landing deck.

Maintenance History: Regularly serviced, most recently in Sept 2009. Engine has 642.5 hours recorded. Blacked in Sept 2009 at Bristol Marina. Anodes – 4 x 2.5kg fitted in 2004. Exterior painted in 2009.

Heating: Webasto 9kw diesel system with additional heating from Belton Bunny solid fuel stove in lounge and Daikin air conditioning/heating system in lounge and bedrooms. Two cylinder water heating – engine & electric. 2 calorifiers. **Electrical Systems:** 12v, split charging, batteries - 1 starter, 12 domestic, 2 bow thruster, 2 leisure. Powermaster 240 v inverter and shoreline. **Capacities:** Fuel 700 litres, Water 1,900 litres, LPG gas – 3 x 13kg cylinders.

Also included: cratch & covers for bow and landing deck; most of contents of boat and dingy with 2hp outboard engine.



Whilst every care has been taken in their preparation, the correctness of these details is not guaranteed. They are intended as a guide only and do not constitute a term of any contract. A prospective buyer is strongly advised to check the particulars and where appropriate to employ a qualified marine surveyor to inspect the vessel.

www.boatsales-uk.com

ABC Leisure Group Ltd Reg. Office: Scarfield Wharf, Alvechurch, Worcestershire B48 7SQ Reg. No. 2860394