

Paladin

£32,000

54ft semi traditional



ABC LEISURE GROUP

Lying at Blackwater Meadow

Telephone 01691 624391

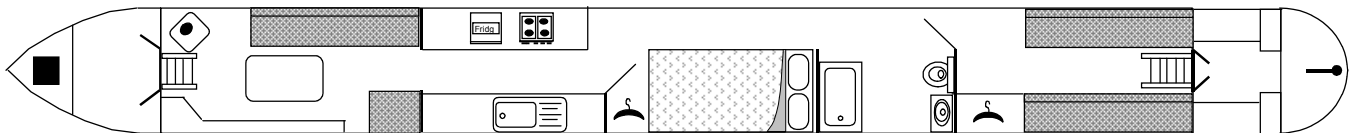

| | | | |
|---------------------------|--------------------|----------------------|-----------|
| Overall length | 54ft 2ins | Beam | 6ft 10ins |
| Draught | 2ft | No. of Berths | 5 |
| Stern | Semi traditional | Licensed | 02/11 |
| Boat Safety Cert. | Yes | Valid to | 04/14 |
| Shell Manufacturer | Marque Narrowboats | Date | 1994 |
| Fitout | JD Narrowboats | Date | 1994 |
| Hull Material | Steel | Thickness | 10/6mm |
| Cabin Material | Steel | Thickness | 4mm |
| Engine | Beta | Model | BV1505 |
| Fuel | Diesel | Cooling | Keel |
| Gearbox | Hurth | Model | HBW125 |

Whilst every care has been taken in their preparation, the correctness of these details is not guaranteed. They are intended as a guide only and do not constitute a term of any contract. A prospective buyer is strongly advised to check the particulars and where appropriate to employ a qualified marine surveyor to inspect the vessel.

www.boatsales-uk.com

ABC Leisure Group Ltd Reg. Office: Scarfield Wharf, Alvechurch, Worcestershire B48 7SQ Reg. No. 2860394

Paladin

£32,000

54ft semi traditional



A 1994 54ft 2ins Marque Narrowboats 5 berth semi traditional narrowboat

Interior: Forward saloon with fixed settee/single berth, rocking chair, table, storage and Becton Bunny solid fuel stove. Galley with Vanette cooker, Electrolux fridge, sink, storage & radio. Central fixed double & wardrobe. Bathroom with hip bath/shower over, Mansfield pump out toilet, basin & storage. Rear cabin with 2 fixed singles & wardrobe. Interior fit out in Sapele and oak faced ply with mahogany panelling.

Maintenance History: Last blacked in Feb 2007. Last serviced 2006. Engine hours – 3516. Anodes fitted in 2004 – 4 x 2.5kg

Heating: Alde Comfort gas heating and Becton Bunny solid fuel stove. Hot water from Alde boiler and calorifier.

Electrical Systems: 12v system with 1 starter and 4 x 6v domestic batteries. Split charging. 240v Mastervolt system 2000VA. Shoreline.

Capacities: Fuel – 150 litres approx. Water – 120 gallons. Propane gas – 2 x 13kg cylinders. Toilet tank – 45 gallons.



Whilst every care has been taken in their preparation, the correctness of these details is not guaranteed. They are intended as a guide only and do not constitute a term of any contract. A prospective buyer is strongly advised to check the particulars and where appropriate to employ a qualified marine surveyor to inspect the vessel.

www.boatsales-uk.com

ABC Leisure Group Ltd Reg. Office: Scarfield Wharf, Alvechurch, Worcestershire B48 7SQ Reg. No. 2860394